

Contents:

Lock Assembly, 2 keys
1/4-20 One-Way Screw
1/4-20 Hex Bolt
Large Washer
Instructions, Warranty Card

Tools Required:

3/16 Allen Wrench or # 30 Torx
7/16 Socket or Adjust. Wrench

Tech Support:

Call 1-800-342-5911

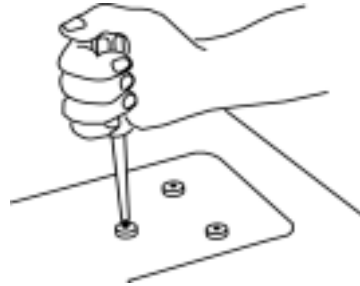

1. Unscrew the single lower handle bolt.

Note: Bedliner panel may have to be removed.



2. Squeeze the top edge of the black plastic insert down to release the top two locking tabs, carefully to prevent breakage.

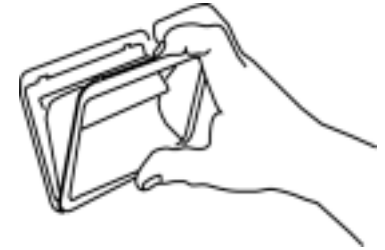

3. Remove the insert by pivoting it on the bottom edge.

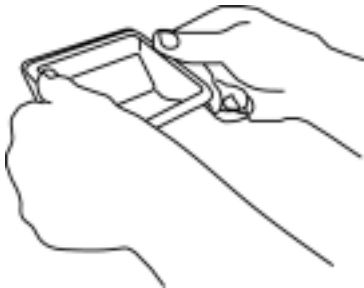

4. Place the insert back hooking it along the top edge but leave the bottom edge sticking out.



5. Lift the handle and insert the POP&LOCK with the lock in the unlocked position.

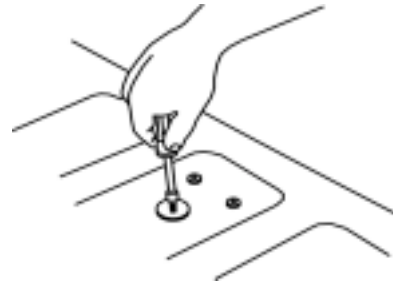

6. Insert the 1/4-20 Hex bolt or One-Way screw and the big washer on the backside of the tailgate and capture the POP&LOCK with a few turns.



7. Push the black plastic insert in fully and tighten the mounting screw .