

Contents:

Lock Assembly
Striker Plate
Alcohol Wipe
Instructions
Warranty Card
Alcohol Wipe

Tools Required:

Torx T-30 Driver
19 MM Socket

Tech Support:

Call 1-800-342-5911

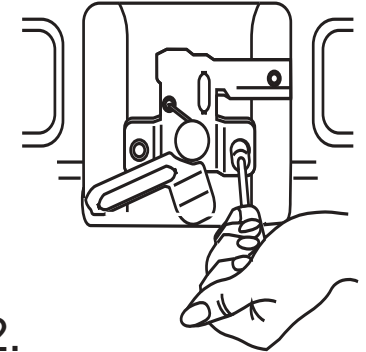
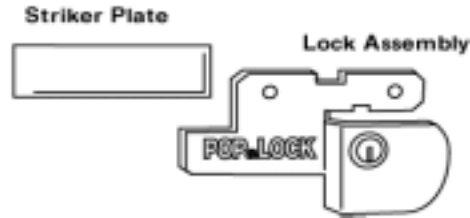

1. Open the tailgate and remove the access panel inside the tailgate using the Torx T-30 Driver.

2. Unscrew the two 10MM nuts holding the Handle Assembly. DO NOT CLOSE TAILGATE FROM THIS POINT ON.

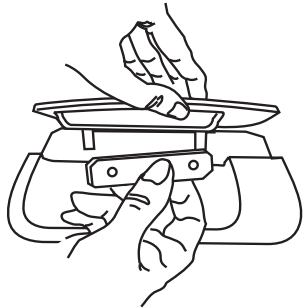

3. Lift out the Handle Assembly and remove the Mounting Bracket located under the Handle.

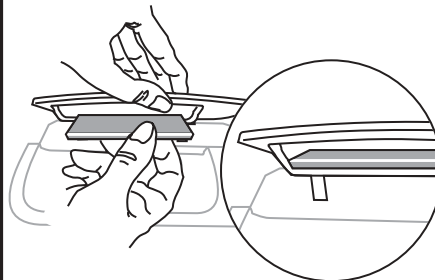

4. Clean the inside of the Handle with the Alcohol wipe and attach the Striker Plate to the interior rear wall with the double-sided tape as shown.

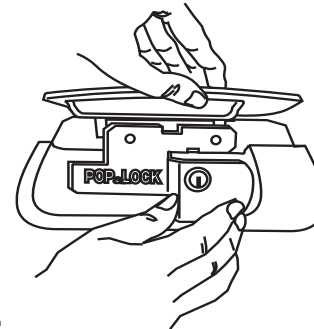

5. Insert the Pop&Lock assembly in place of the Mounting Bracket.

6. Re-install the Handle Assembly and tighten the two 10MM nuts. Close the tailgate and test the Pop&Lock.

Re-install the Access Panel.