

PL6000 Contents:

Lock Bezel, 2 keys, Bracket,
Bolt Linkage, Crank Linkage
2 Bolts #8-16 x 1 1/2
1 Bolt #10-18 x 3/8
Instructions, Warranty Card

Tools Required:

8 and 10 MM Sockets
Power Drill, 5 & 12 MM Drill Bits
T40 Torx & Philips Head Driver
Rubber Mallet, Torque Wrench

IMPORTANT: Hand tighten all bolts

Tech Support:

Call 1-800-342-5911

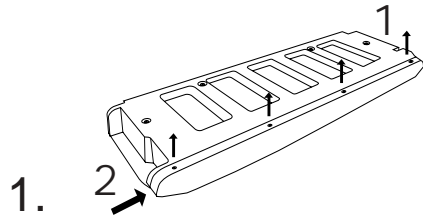

1. Lower the tailgate. 1. Remove the 4 philips bolts from the top trim and 2. slide the top trim to the right using a rubber mallet and remove it. Remove the 16 white clips that remain on the tailgate by turning them 45° to pull out.

Remove the 4 T40 Torx bolts holding the trim panel and lift it off.

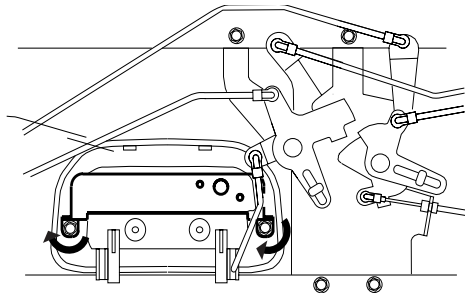

2. Mount the Bracket over the handle bezel as shown above and in Fig. 3 using the existing two 6 MM Bolts. It may be helpful to swing the handle rod out of the way.

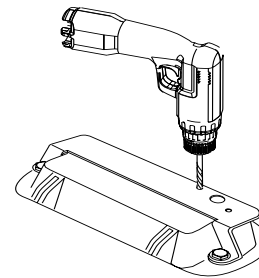

3. Using the holes in the Bracket as a guide, drill 2 holes 5 MM and on hole 12 MM through the handle bezel.

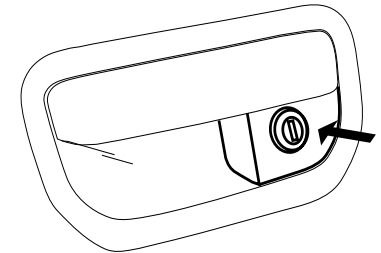

4. Install the Lock Bezel from below as shown and hold it in place with one hand while inserting one of the M5 x 30 bolts from above with the other hand.

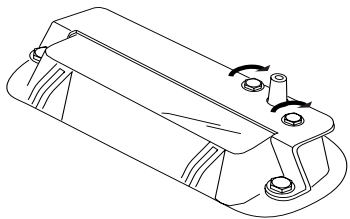

5. Hand tighten both M5 x 30 bolts to secure the Lock Bezel.

Back off on the bolts if the lock doesn't turn freely.

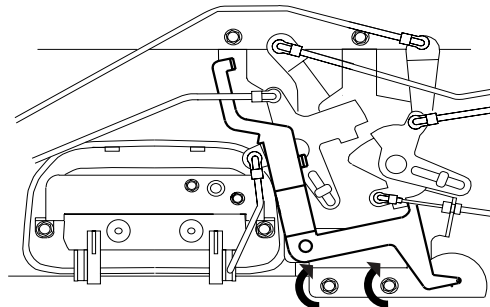

6. Place the Bolt Linkage under the upper rod as shown and bolt it in place using the existing two M5 Bolts..

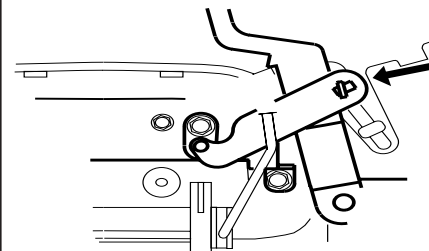

7. Hook slotted end of the Crank Link onto the Bolt Link as shown.

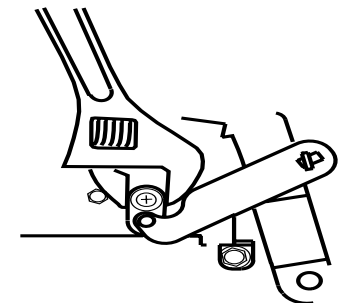

8. Secure the Crank Link to the Lock with the 10-18 x 3/8 screw. **IMPORTANT;** Hold the crank with a crescent wrench to avoid damage to the lock mechanism as you tighten.